

# VENUS SERIES ALL ELECTRIC INJECTION MOLDING MACHINE

## VE900

### Metric Datasheet

#### CLAMPING UNIT

Clamping force (kN)				900
Toggle stroke (mm)				320
Min. mold height (mm)				150
Max. mold height (mm)				380
Max. mold opening stroke (mm)				700
Space between tie bars (mm)		420	x	370
Min. mold dimension (mm)		270	x	240
Ejector stroke (mm)				80
Ejector force (kN)				19.6
Mold platen dimension (mm)		615	x	570

INJECTION UNIT	120h - high speed			120 - standard			210h - high speed			210 - standard		
	A	B	C	A	B	C	A	B	C	A	B	C
Screw diameter (mm)	22	26	30	22	26	30	28	32	36	28	32	36
Screw L/D ratio	20	20	17.4	20	20	17.4	21	21	18.6	21	21	18.6
Shot size (theoretical)	36	58	78	36	58	78	70	100	127	70	100	127
Injection weight (g)	33	52	70	33	52	70	64	91	116	64	91	116
Injection speed (mm/sec)		350			150			350			150	
Injection rate (g/sec)	121	169	225	52	72	96	196	256	324	84	110	139
Injection pressure	(Mpa)	280	220	150	280	220	150	260	200	160	260	200
	(bar)	2850	2040	1530	2850	2040	1530	2650	2040	1630	2650	2040
Holding pressure	(Mpa)	220	160	120	220	160	120	206	160	126	206	160
	(bar)	2240	1630	1220	2240	1630	1220	2100	1630	1280	2100	1630
Screw speed (rpm)	400	400	400	400	400	400	400	400	400	400	400	400
Plasticizing capacity (g/sec)	6	8.8	13	6	8.8	13	11	16	22	11	16	22
Nozzle touch force (kN)					19.6						19.6	
Nozzle movement distance (mm)					310						330	
Heating power (kW)	5.4	7	7	5.4	7	7	7	8.6	8.6	7	8.6	8.6

#### OTHERS

Connection power (kW)		25			15.1			31			20
Hopper capacity (liter)		15			15			25			25
Machine dimension (l x w x h) (m)	4.19	x	1.43	x	1.83		4.38	x	1.43	x	1.83
Machine weight (metric ton)				4.3						4.6	



Specifications subject to change without notice.

# VENUS SERIES ALL ELECTRIC INJECTION MOLDING MACHINE

## VE900

### English Datasheet

#### CLAMPING UNIT

Clamping force (US tons)			101
Toggle stroke (in)			12.60
Min. mold height (in)			5.91
Max. mold height (in)			14.96
Max. mold opening stroke (in)			27.56
Space between tie bars (in)	16.54	x	14.57
Min. mold dimension (in)	10.63	x	9.45
Ejector stroke (in)			3.15
Ejector force (US tons)			2.20
Mold platen dimension (in)	24.21	x	22.44

INJECTION UNIT	120h - high speed			120 - standard			210h - high speed			210 - standard			
	A	B	C	A	B	C	A	B	C	A	B	C	
Screw diameter (in)	0.87	1.02	1.18	0.87	1.02	1.18	1.10	1.26	1.42	1.10	1.26	1.42	
Screw L/D ratio	20	20	17.4	20	20	17.4	21	21	18.6	21	21	18.6	
Shot size (theoretical) (cu. cm)	36	58	78	36	58	78	70	100	127	70	100	127	
Injection weight (oz. GPPS)	1.16	1.83	2.47	1.16	1.83	2.47	2.26	3.21	4.09	2.26	3.21	4.09	
Injection speed (in/sec)		13.78			5.91			13.78			5.91		
Injection rate (oz./sec)	4.27	5.96	7.94	1.83	2.54	3.39	6.91	9.03	11.43	2.96	3.88	4.90	
Injection pressure	(psi)	40611	31909	21756	40611	31909	21756	37710	29008	23206	37710	29008	23206
	(bar)	2850	2040	1530	2850	2040	1530	2650	2040	1630	2650	2040	1630
Holding pressure	(psi)	31909	23206	17405	31909	23206	17405	29878	23206	18275	29878	23206	18275
	(bar)	2240	1630	1220	2240	1630	1220	2100	1630	1280	2100	1630	1280
Screw speed (rpm)	400	400	400	400	400	400	400	400	400	400	400	400	
Plasticizing capacity (oz./sec)	0.21	0.31	0.46	0.21	0.31	0.46	0.39	0.56	0.78	0.39	0.56	0.78	
Nozzle touch force (US tons)				2.2						2.2			
Nozzle movement distance (in)				12.20						12.99			
Heating power (kW)	3.8	5.4	5.4	3.8	5.4	5.4	3.8	5.4	5.4	3.8	5.4	5.4	

#### OTHERS

Connection power (kW)		25		15.1		31		20		
Hopper capacity (lbs GPPS)		21		21		35		35		
Machine dimension (l x w x h)	166	x	57	x	73	174	x	57	x	73
Machine weight (lbs)			9482					10143		



Specifications subject to change without notice.

unit: mm

Machine dimensions VE900

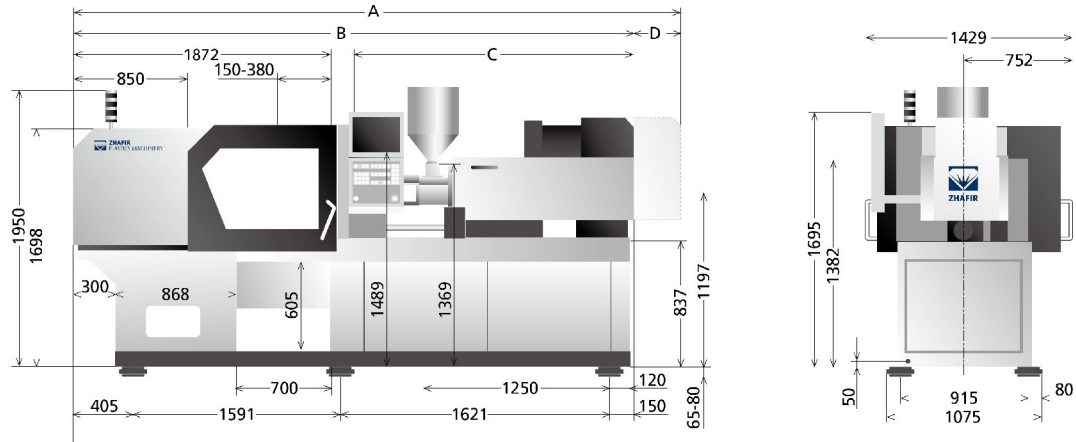

Platen dimensions VE900

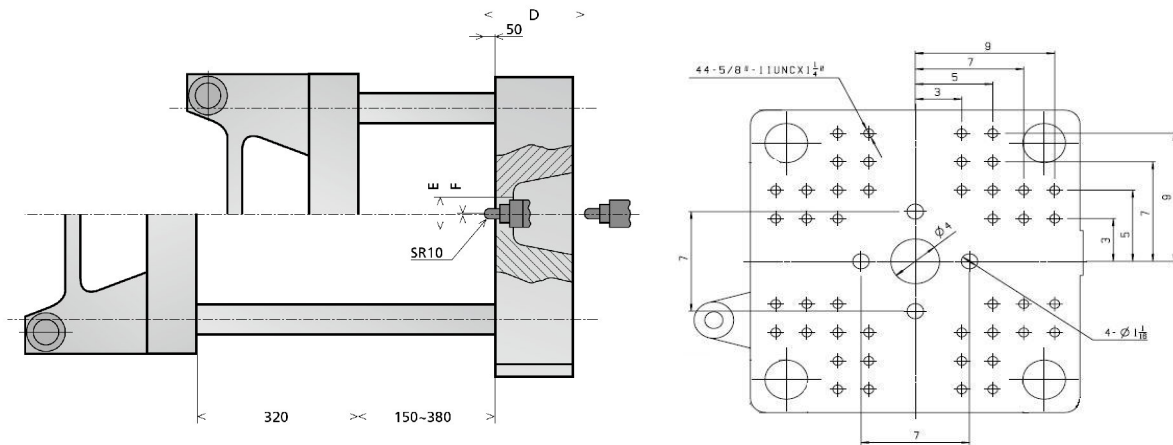

Mold mounting and ejector locations in Inches.

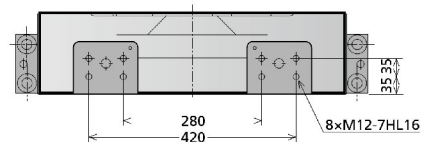
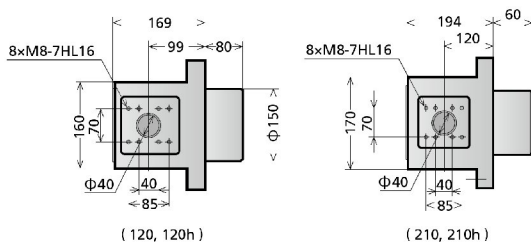

	A	B	C	D	E	F
120, 120h	4188	3878	1836	310	Φ100	Φ2
210, 210h	4380	4050	2008	330	Φ125	Φ3